

## DR-H (標準タイプ) RoHS

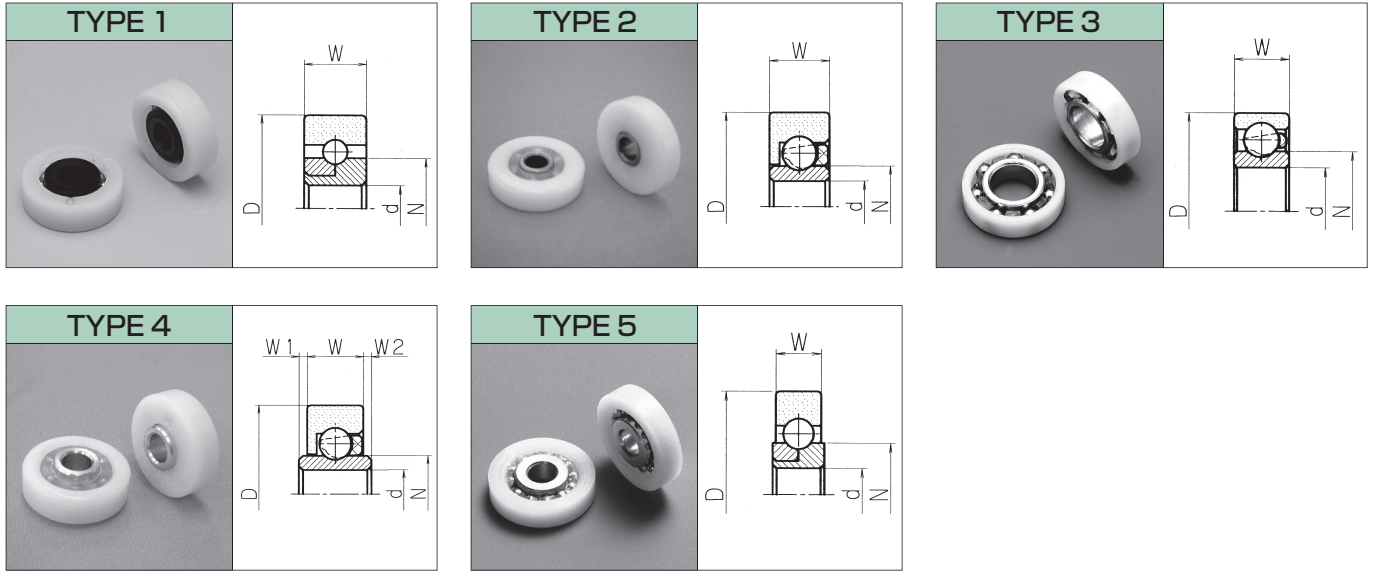

Code	Part No.	D <sub>-0.1</sub> [mm]	d <sup>+0.1</sup> <sub>0</sub> [mm]	W <sub>-0.2</sub> [mm]	W1*1 [mm]	W2*1 [mm]	N [mm]	Load *2 [N] (kgf)	Type	Q'ty [pcs/box]	Gross Weight [kg/box]
040012	DRS-9-H2.5	9 <sub>-0.05</sub>	2.5 <sup>+0.05</sup> <sub>0</sub>	3 <sup>±0.1</sup>	—	—	(5.4)	9.8 ( 1)	1	10,000	—
040013	DRS-12-H3	12 <sub>-0.05</sub>	3 <sup>+0.05</sup> <sub>0</sub>	4 <sup>±0.1</sup>	—	—	(6.5)	9.8 ( 1)	1	10,000	—
040100	DR-18-H6	18	6	6	—	—	(8.2)	49 ( 5)	2	2,500	7.6
040202	DR-19-H5	19	5	6	—	—	(8.2)	49 ( 5)	2	2,500	8.9
040205	DR-19-H6	19	6	6	—	—	(8.2)	49 ( 5)	2	2,500	8.1
040301	DR-20-H8	20	8	6 <sup>±0.1</sup>	—	—	(11.0)	29.4 ( 3)	2	1,500	6.1
040401	DR-22-H6	22	6	7	—	—	(9.5)	196 (20)	2	1,500	9.5
040412	DR-22-H8	22	8	7	—	—	(11.0)	49 ( 5)	2	1,500	8.2
040600	DR-24-H6	24	6	7	—	—	(9.5)	196 (20)	2	1,000	7.1
040602	DR-24-H10.5	24	10.5	7	—	—	(13.0)	49 ( 5)	2	1,000	11.5
040701	DR-26-H6	26	6	7	—	—	(9.5)	196 (20)	2	1,000	7.8
041600	DR-26-H10	26	10	8	—	—	(13.0)	196 (20)	2	1,000	7.9
040800	DR-28-H6	28	6	7	—	—	(9.5)	196 (20)	2	500	4.2
041000	DR-30-H6	30	6	7	—	—	(9.5)	196 (20)	2	500	5.6
041610	DR-30-H10-9	30	10	9	—	—	(14.5)	245 (25)	2	500	7.7
041005	DR-30-H10-8	30	10	8 <sup>±0.1</sup>	—	—	(14.5)	245 (25)	2	500	6.7
041612	DR-32-H12	32	12	10	—	—	(17.0)	294 (30)	2	500	9.6
041100	DR-35-H6	35	6	7	—	—	(9.5)	196 (20)	2	500	5.7
041614	DR-35-H15	35	15	11 <sup>±0.2</sup>	—	—	(21.0)	294 (30)	2	400	10.6
041151	DR-38-H10	38	10	8 <sup>±0.2</sup>	—	—	(13.0)	196 (20)	2	500	6.1
041200	DR-40-H6	40 <sub>-0.2</sub>	6	8	—	—	(9.5)	196 (20)	2	400	5.4
041616	DR-40-H17	40	17	12 <sup>±0.2</sup>	—	—	(21.0)	294 (30)	2	250	6.9
041618	DR-47-H20	47	20	14	—	—	(27.0)	343 (35)	2	150	8.7
040102	DR-18-H8	18	8	5	—	—	(11.0)	49 ( 5)	3	3,000	8.7
040007	DR-16-H4.1W0.25	16	4.1	4	0.25	0.25	(8.5)	19.6 ( 2)	4	4,000	9.6
040200	DR-19-H4W (1.3) 3	19	4	6	1.3	3	(8.2)	49 ( 5)	4	1,500	8.2
040204	DR-19-H5W (0) 2.3	19	5	6	0	2.3	(8.2)	49 ( 5)	4	2,000	8.6
040400	DR-22-H4W (0.5) 3	22	4	7	0.5	3	(9.5)	196 (20)	4	1,000	8.3
040415	DR-22-H6W1	22	6	7	1	1	(9.5)	196 (20)	4	1,000	6.6
040601	DR-24-H6W1	24	6	7	1	1	(9.5)	196 (20)	4	1,000	7.3
040700	DR-26-H4W (0.5) 3	26	4	7	0.5	3	(9.5)	196 (20)	4	1,000	9.7
040704	DR-26-H6W1	26	6	7	1	1	(9.5)	196 (20)	4	1,000	8.8
040802	DR-28-H6W1	28	6	7	1	1	(9.5)	196 (20)	4	500	4.5
041003	DR-30-H6W1	30	6	7	1	1	(9.5)	196 (20)	4	500	6.4
041101	DR-35-H6W1	35	6	7	1	1	(9.5)	196 (20)	4	500	6.8
041201	DR-40-H6W0.5	40 <sub>-0.2</sub>	6	8	0.5	0.5	(9.5)	196 (20)	4	400	5.5
041300	DR-47-H8W (0) 9	47	8	14	0	9	(27.0)	196 (20)	4	100	3.5
040005	DRS-16-H4.1W0.25	16	4.1	3.5 <sup>±0.2</sup>	0.25	0.25	(8.0)	49 ( 5)	5	5,000	11.0

\*1 参考値 Reference Dimension \*2 許容荷重 (毎分300回 回転時) Allowable Load at 300min<sup>-1</sup> (300r.p.m)

\*3 上記以外のサイズ・形状につきましては、弊社までご相談ください。Each limiting size can be changed for practical application. Please ask our engineer for further information.

## DR-B (ネジ軸タイプ) RoHS

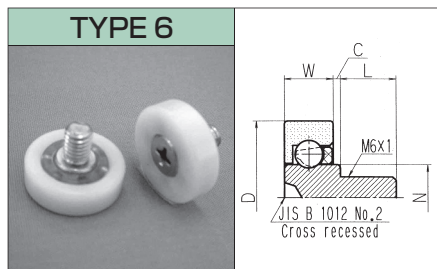

Code	Part No.	D <sub>-0.1</sub> [mm]	W <sub>-0.2</sub> [mm]	C <sup>±0.4</sup> [mm]	L <sup>±0.5</sup> [mm]	N [mm]	Load <sup>*1</sup> [N] (kgf)	Type	Q'ty [pcs/box]	Gross Weight [kg/box]
020200	DR-19-B0.5	19	6	0.5	8	(8.2)	49 ( 5)	6	2,000	12.5
020207	DR-19-B1-14	19	6	1	14	(8.2)	49 ( 5)	6	1,500	11.1
020208	DR-19-B1.5	19	6	1.5	8	(8.2)	49 ( 5)	6	2,000	12.9
020212	DR-19-B3.5	19	6	3.5	8	(8.2)	49 ( 5)	6	1,500	11.0
020404	DR-22-B0.5-4.5	22	7	0.5	4.5	(9.5)	196 (20)	6	1,000	8.4
020400	DR-22-B0.5	22	7	0.5	8	(9.5)	196 (20)	6	1,000	9.8
020408	DR-22-B1-10	22	7	1	10	(9.5)	196 (20)	6	1,000	9.5
020428	DR-22-B3-10.5	22	7	3	10.5	(9.5)	196 (20)	6	1,000	11.5
020427	DR-22-B3.6-12.4	22	7	3.6	12.4	(9.5)	196 (20)	6	1,000	10.9
020415	DR-22-B3.6-14.5	22	7	3.6	14.5	(9.5)	196 (20)	6	1,000	11.9
020600	DR-24-B0.5	24	7	0.5	8	(9.5)	196 (20)	6	1,000	10.4
020608	DR-24-B3-10.5	24	7	3	10.5	(9.5)	196 (20)	6	1,000	11.7
020702	DR-26-B0.5-4.5	26	7	0.5	4.5	(9.5)	196 (20)	6	1,000	9.7
020700	DR-26-B0.5	26	7	0.5	8	(9.5)	196 (20)	6	1,000	10.1
020720	DR-26-B3-10.5	26	7	3	10.5	(9.5)	196 (20)	6	800	10.7
020719	DR-26-B3.6-12.4	26	7	3.6	12.4	(9.5)	196 (20)	6	800	11.3
020714	DR-26-B5-11	26	7	5	11	(9.5)	196 (20)	6	800	8.8
020800	DR-28-B0.5	28	7	0.5	8	(9.5)	196 (20)	6	500	6.7
020803	DR-28-B2-15	28	7	2	15	(9.5)	196 (20)	6	500	6.7
020805	DR-28-B3-10.5	28	7	3	10.5	(9.5)	196 (20)	6	500	6.9
021000	DR-30-B0.5	30	7	0.5	8	(9.5)	196 (20)	6	500	6.8
021005	DR-30-B3-10.5	30	7	3	10.5	(9.5)	196 (20)	6	500	7.6
021004	DR-30-B3.6-12.4	30	7	3.6	12.4	(9.5)	196 (20)	6	500	12.5

\*1 許容荷重 (毎分 300 回 回転時) Allowable Load at 300min<sup>-1</sup> (300r.p.m)

\*2 上記以外のサイズ・形状につきましては、弊社までご相談ください。

Each limiting size can be changed for practical application. Please ask our engineer for further information.

## DR-B (ネジ軸タイプ) RoHS

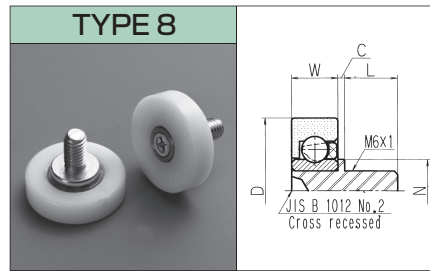
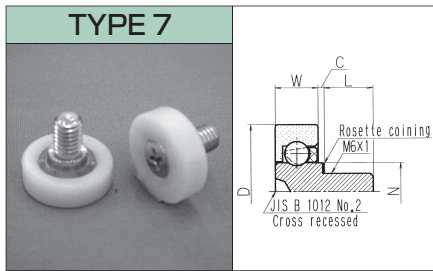

Code	Part No.	D <sub>-0.1</sub> [mm]	W <sub>-0.2</sub> [mm]	C <sup>±0.4</sup> [mm]	L <sup>±0.5</sup> [mm]	N [mm]	Load <sup>*1</sup> [N] (kgf)	Type	Q'ty [pcs/box]	Gross Weight [kg/box]
020205	DR-19-B1-5.5	19	6	1	5.5	(8.2)	49 ( 5)	7	2,000	11.5
020204	DR-19-B1	19	6	1	8	(8.2)	49 ( 5)	7	2,000	13.5
020210	DR-19-B2-4.5	19	6	2	4.5	(8.2)	49 ( 5)	7	2,000	12.1
020209	DR-19-B2	19	6	2	8	(8.2)	49 ( 5)	7	2,000	14.0
020211	DR-19-B2.7	19	6	2.7	8	(8.2)	49 ( 5)	7	1,500	10.2
020214	DR-19-B3	19	6	3	8	(8.2)	49 ( 5)	7	1,500	10.7
020406	DR-22-B1	22	7	1	8	(9.5)	196 (20)	7	1,000	9.0
020411	DR-22-B2-5.5	22	7	2	5.5	(9.5)	196 (20)	7	1,000	9.3
020409	DR-22-B2	22	7	2	8	(9.5)	196 (20)	7	1,000	10.3
020413	DR-22-B3	22	7	3	8	(9.5)	196 (20)	7	1,000	11.3
020418	DR-22-B4-4.5	22	7	4	4.5	(9.5)	196 (20)	7	1,000	10.3
020416	DR-22-B4	22	7	4	8	(9.5)	196 (20)	7	1,000	11.7
020420	DR-22-B5	22	7	5	8	(9.5)	196 (20)	7	1,000	12.3
020422	DR-22-B6	22	7	6	8	(9.5)	196 (20)	7	1,000	12.8
020602	DR-24-B2	24	7	2	8	(9.5)	196 (20)	7	1,000	11.4
020604	DR-24-B3	24	7	3	8	(9.5)	196 (20)	7	1,000	11.7
020605	DR-24-B4	24	7	4	8	(9.5)	196 (20)	7	1,000	12.4
020606	DR-24-B5	24	7	5	8	(9.5)	196 (20)	7	1,000	12.5
020607	DR-24-B6	24	7	6	8	(9.5)	196 (20)	7	1,000	13.3
020705	DR-26-B2	26	7	2	8	(9.5)	196 (20)	7	800	9.2
020707	DR-26-B3	26	7	3	8	(9.5)	196 (20)	7	800	9.7
020710	DR-26-B4	26	7	4	8	(9.5)	196 (20)	7	800	10.1
020716	DR-26-B6-6	26	7	6	6	(9.5)	196 (20)	7	800	10.7
020715	DR-26-B6	26	7	6	8	(9.5)	196 (20)	7	800	11.1
020801	DR-28-B2	28	7	2	8	(9.5)	196 (20)	7	500	6.7
021002	DR-30-B3	30	7	3	8	(9.5)	196 (20)	7	500	11.3
020429	DR-22-BH2-11	22	7	2	11	(13.0)	196 (20)	8	1,000	12.3
020430	DR-22-BH3-11	22	7	3	11	(11.0)	196 (20)	8	1,000	11.4
020722	DR-26-BH2-11	26	7	2	11	(13.0)	196 (20)	8	800	10.6
020804	DR-28-BH2-11	28	7	2	11	(13.0)	196 (20)	8	500	6.9

\*1 許容荷重 (毎分 300 回 回転時) Allowable Load at 300min<sup>-1</sup> (300r.p.m)

\*2 上記以外のサイズ・形状につきましては、弊社までご相談ください。

Each limiting size can be changed for practical application. Please ask our engineer for further information.

## DR-A (カシメ軸タイプ) RoHS

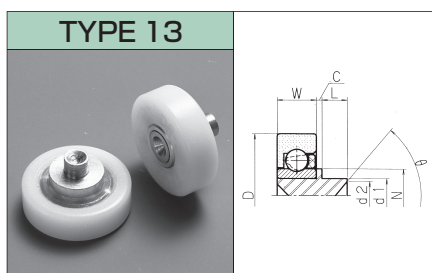
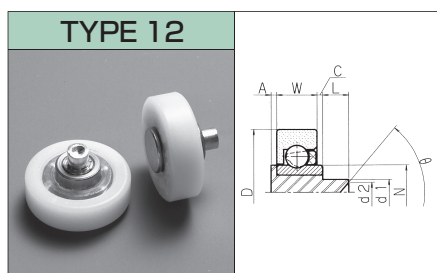
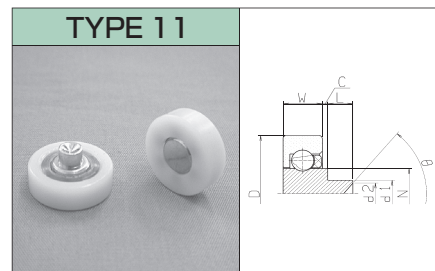
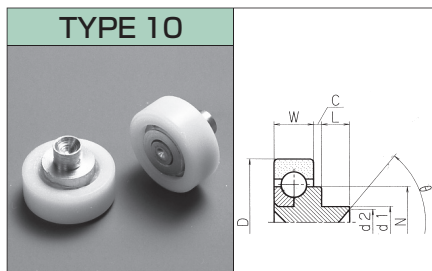
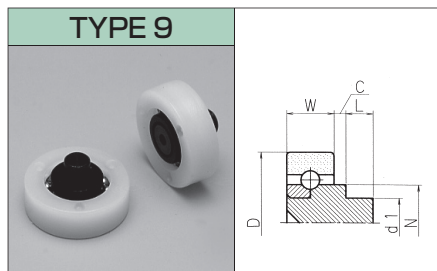

Code	Part No.	D <sup>0</sup> <sub>-0.1</sub> [mm]	d1 <sup>0</sup> <sub>-0.1</sub> [mm]	W <sup>0</sup> <sub>-0.2</sub> [mm]	C <sup>±0.4</sup> [mm]	L <sup>±0.2</sup> [mm]	(d2×θ) <sup>*1</sup>	A <sup>±0.2</sup> [mm]	N [mm]	Load <sup>*2</sup> [N] (kgf)	Type	Q'ty [pcs/box]	Gross Weight [kg/box]
000006	DRS-9-A0.5	9 <sup>0</sup> <sub>-0.05</sub>	2 <sup>0</sup> <sub>-0.05</sub>	3 <sup>0</sup> <sub>-0.1</sub>	0.5	1.8	—	—	(4.0)	[9.8] ( 1)	9	10,000	—
000007	DRS-12-A0.5	12 <sup>0</sup> <sub>-0.05</sub>	3 <sup>0</sup> <sub>-0.05</sub>	4 <sup>±0.1</sup>	0.5 <sup>±0.3</sup>	2.3	—	—	(6.5)	[9.8] ( 1)	9	10,000	—
000001	DRS-16-A1	16 <sup>0</sup> <sub>-0.3</sub>	4	5 <sup>±0.2</sup>	1	3.5	φ3 ×100°	—	(9.0)	19.6 ( 2)	10	2,000	9.0
000003	DRS-16-A1.5	16 <sup>0</sup> <sub>-0.3</sub>	5	6.35 <sup>±0.2</sup>	1.5	3.5	φ4.5× 90°	—	(9.0)	19.6 ( 2)	10	2,500	14.4
000100	DR-18-A0.5	18	5	6	0.5	3.5	φ4 ×120°	—	(8.2)	19.6 ( 2)	11	2,000	9.6
000200	DR-19-A0.5	19	5	6	0.5	3.5	φ4 ×120°	—	(8.2)	29.4 ( 3)	11	2,000	10.7
000207	DR-19-A2	19	5	6	2	3.5	φ4.4×120°	—	(8.2)	29.4 ( 3)	11	2,000	11.6
000400	DR-22-A1	22	5	7	1	3.5	φ4.4× 90°	—	(9.5)	78.4 ( 8)	11	1,000	9.0
000410	DR-22-A2-φ6	22	6	7	2	3.5	φ5.5× 90°	—	(9.5)	78.4 ( 8)	11	1,000	9.4
000411	DR-22-A2	22	5	7	2	3.5	φ4 × 90°	—	(9.5)	78.4 ( 8)	11	1,000	8.9
000600	DR-24-A1	24	5	7	1	3.5	φ4.4× 90°	—	(9.5)	78.4 ( 8)	11	1,000	9.5
000700	DR-26-A1	26	5	7	1	3.5	φ4.4× 90°	—	(9.5)	78.4 ( 8)	11	1,000	10.2
000800	DR-28-A1	28	5	7	1	3.5	φ4.4× 90°	—	(9.5)	78.4 ( 8)	11	500	5.8
000900	DR-29-A1	29	5	7	1	3.5	φ4.4× 90°	—	(9.5)	78.4 ( 8)	11	500	5.7
000427	DR-22-AH(1)3.5-8019	22	4.5 <sup>±0.1</sup>	7	0	3.5 <sup>+0.3</sup> <sub>0</sub>	nothing	1	(9.5)	196 (20)	12	1,000	9.1
000419	DR-22-AH2.5-3.65	22	4.5 <sup>±0.1</sup>	7	2.5	3.65	φ2.5×100°	1	(9.5)	196 (20)	12	1,000	10.2
000705	DR-26-AH	26	4.5 <sup>±0.1</sup>	7	0	3.5 <sup>+0.3</sup> <sub>0</sub>	nothing	1 <sup>±0.3</sup>	(9.5)	196 (20)	12	1,000	10.2
000707	DR-26-AH2.5-3.65	26	4.5 <sup>±0.1</sup>	7	2.5	3.65	φ2.5×100°	1	(9.5)	196 (20)	12	800	8.8
040707	DR-26-AH2.7-2.7	26	3.9 <sup>0</sup> <sub>-0.2</sub>	7	2.7	2.7	φ2.3×110°	1 <sup>±0.3</sup>	(9.5)	196 (20)	12	800	8.8
040706	DR-26-AH2.7-4	26	3.9 <sup>0</sup> <sub>-0.2</sub>	7	2.7	4 <sup>±0.3</sup>	φ2.7×120°	1 <sup>±0.3</sup>	(9.5)	196 (20)	12	800	9.8
000414	DR-22-AH2.5	22	5	7	2.5	3.5	φ4 ×110°	—	(11.0)	196 (20)	13	1,000	10.0
000416	DR-22-AH3.8-2.5	22	4.9	7	3.8	2.5	nothing	—	(11.0)	196 (20)	13	1,000	10.6
000417	DR-22-AH4	22	5	7	4	3.5	φ4 ×110°	—	(11.0)	196 (20)	13	1,000	10.8
000706	DR-26-AH4	26	5	7	4	3.5	φ4 ×110°	—	(11.0)	196 (20)	13	800	9.8

\*1 参考値 Reference Dimension

\*2 許容荷重 (毎分300回 回転時) Allowable Load at 300min<sup>-1</sup> (300r.p.m)

\*3 上記以外のサイズ・形状につきましては、弊社までご相談ください。Each limiting size can be changed for practical application. Please ask our engineer for further information.

## 六角ネジ穴タイプベアリング

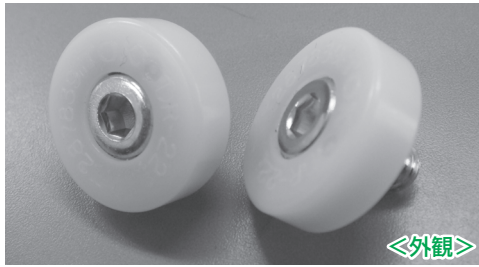

### <特長> RoHS

- 高い締め付け力で、ゆるみの防止による信頼性の向上
- 狭いスペースの適用と作業性の向上

#### TYPE DR

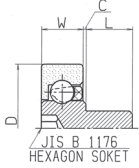

TYPE	CODE	Part No.	D <sub>-0.1</sub> [mm]	W <sub>-0.2</sub> [mm]	C <sup>+0.4</sup> [mm]	L <sup>+0.5</sup> [mm]	使用六角レンチ
DR	020561	DR-22-BO.5-JH	22	7	0.5	M6×8	呼び4
DR	020611	DR-24-BO.5-JH	24	7	0.5	M6×8	呼び4
DR	020744	DR-26-BO.5-JH	26	7	0.5	M6×8	呼び4
DR	020808	DR-28-BO.5-JH	28	7	0.5	M6×8	呼び4
DR	021013	DR-30-BO.5-JH	30	7	0.5	M6×8	呼び4
DR	021103	DR-35-BO.5-JH	35	7	0.5	M6×8	呼び4

#### TYPE DO

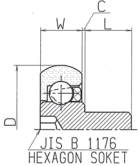

TYPE	CODE	Part No.	D <sub>-0.1</sub> [mm]	W <sub>-0.2</sub> [mm]	C <sup>+0.4</sup> [mm]	L <sup>+0.5</sup> [mm]	使用六角レンチ
DO	071066	DO-22-BO.5-JH	22	7	0.5	M6×8	呼び4
DO	071037	DO-24-BO.5-JH	24	7	0.5	M6×8	呼び4
DO	071069	DO-26-BO.5-JH	26	7	0.5	M6×8	呼び4
DO	071054	DO-28-BO.5-JH	28	7	0.5	M6×8	呼び4
DO	071070	DO-30-BO.5-JH	30	7	0.5	M6×8	呼び4
DO	071071	DO-35-BO.5-JH	35	7	0.5	M6×8	呼び4

#### TYPE DU

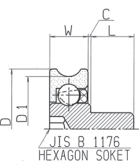

TYPE	CODE	Part No.	D <sup>+0.2</sup> [mm]	D1 <sup>+0.1</sup> [mm]	W <sub>-0.2</sub> [mm]	C <sup>+0.4</sup> [mm]	L <sup>+0.5</sup> [mm]	使用六角レンチ
DU	081086	DU-22-BO.5-JH	22	19.2	7	0.5	M6×8	呼び4
DU	081036	DU-24-BO.5-JH	24	21.2	7	0.5	M6×8	呼び4
DU	081044	DU-26-BO.5-JH	26	23.2	7	0.5	M6×8	呼び4
DU	081052	DU-28-BO.5-JH	28	24	7	0.5	M6×8	呼び4
DU	081065	DU-30-BO.5-JH	30	25.7	7	0.5	M6×8	呼び4
DU	081066	DU-35-BO.5-JH	35	31	7	0.5	M6×8	呼び4

#### TYPE DV

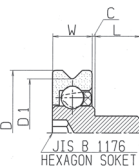

TYPE	CODE	Part No.	D <sup>+0.2</sup> [mm]	D1 <sup>+0.2</sup> [mm]	W <sub>-0.2</sub> [mm]	C <sup>+0.4</sup> [mm]	L <sup>+0.5</sup> [mm]	使用六角レンチ
DV	091104	DV-22-BO.5-JH	22	19	7	0.5	M6×8	呼び4
DV	091203	DV-24-BO.5-JH	24	21	7	0.5	M6×8	呼び4
DV	091305	DV-26-BO.5-JH	26	23	7	0.5	M6×8	呼び4
DV	091400	DV-28-BO.5-JH	28	24	7	0.5	M6×8	呼び4
DV	091505	DV-30-BO.5-0.5R-JH	30	28	7	0.5	M6×8	呼び4
DV	091506	DV-30-BO.5-JH	30	27	7	0.5	M6×8	呼び4

#### TYPE DH

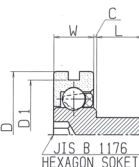

TYPE	CODE	Part No.	D <sup>+0.2</sup> [mm]	D1 <sup>+0.2</sup> [mm]	W <sub>-0.2</sub> [mm]	C <sup>+0.4</sup> [mm]	L <sup>+0.5</sup> [mm]	使用六角レンチ
DH	101022	DH-19-BO.5-2-JH	22	19	7	0.5	M6×8	呼び4
DH	101041	DH-21-BO.5-2-JH	24	21	7	0.5	M6×8	呼び4

#### TYPE ER

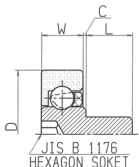

TYPE	CODE	Part No.	D[mm]	W[mm]	C <sup>+0.4</sup> [mm]	L <sup>+0.5</sup> [mm]	使用六角レンチ
ER	720115	ER-22-BO.5-JH	22 <sup>+0.2</sup>	7 <sub>-0.2</sub>	0.5	M6×8	呼び4
ER	720116	ER-24-BO.5-JH	24 <sub>-0.1</sub>	7 <sub>-0.2</sub>	0.5	M6×8	呼び4
ER	720117	ER-26-BO.5-JH	26 <sub>-0.1</sub>	7 <sub>-0.3</sub>	0.5	M6×8	呼び4
ER	720118	ER-28-BO.5-JH	28 <sub>-0.1</sub>	7 <sub>-0.2</sub>	0.5	M6×8	呼び4
ER	720119	ER-30-BO.5-JH	30 <sub>-0.1</sub>	7 <sub>-0.4</sub>	0.5	M6×8	呼び4
ER	720120	ER-35-BO.5-JH	35 <sub>-0.1</sub>	7 <sub>-0.4</sub>	0.5	M6×8	呼び4

\* 別途ご確認をお願いします。



## DR-S (ステンレス仕様) RoHS

アウターレースはポリアセタール樹脂を使用し、インナーレース、ボールにステンレスを使用したベアリングです。

The outer race are made of polyacetal resin, and the inner race and balls are made of stainless steel.

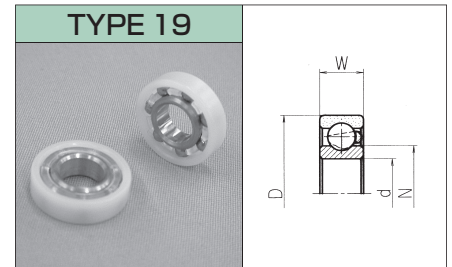
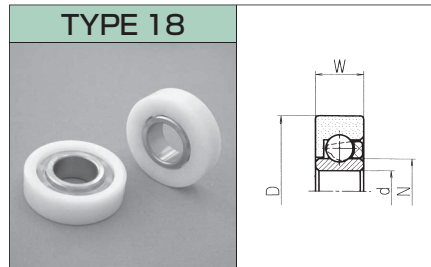
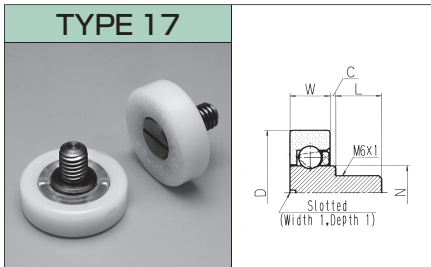
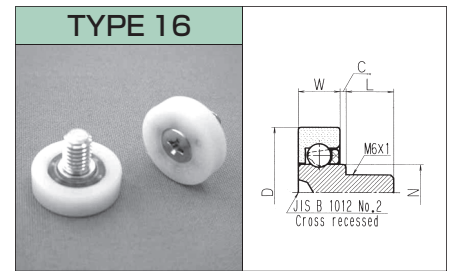
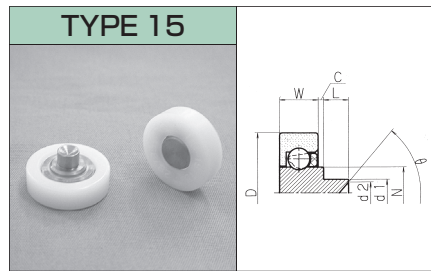
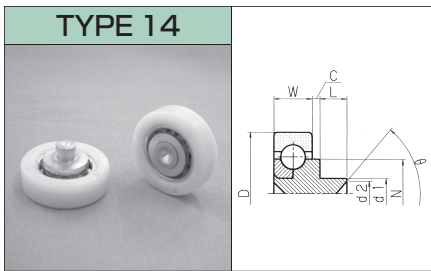

Code	Part No.	D <sub>-0.1</sub> <sup>0</sup> [mm]	d <sub>0</sub> <sup>+0.1</sup> [mm]	d1 <sub>-0.1</sub> [mm]	W <sub>-0.2</sub> [mm]	C <sup>+0.4</sup> [mm]	L <sup>±0.2</sup> [mm]	(d2×θ) <sup>*1</sup>	N [mm]	Load <sup>*2</sup> [N] (kgf)	Type	Q'ty [pcs/box]	Gross Weight [kg/box]
000002	DRS-16-SAS1-GN	16 <sub>-0.3</sub> <sup>0</sup>	—	4	5 <sup>±0.2</sup>	1	3.5	φ3×100°	(9.0)	—	14	2,000	9.0
000202	DR-19-SAS0.5-GN	19	—	5	6	0.5	3.5 <sub>-0.2</sub> <sup>0</sup>	φ4×120°	(8.2)	—	15	2,000	10.7
000421	DR-22-SAS1	22	—	5	7	1 <sup>±0.3</sup>	3.4 <sup>±0.1</sup>	φ4×90°	(9.5)	—	15	1,000	9.0
020202	DR-19-SBS0.5	19	—	—	6	0.5	8 <sup>±0.5</sup>	—	(8.2)	—	16	2,000	12.5
020442	DR-22-SBS0.5-GN	22	—	—	7	0.5	8 <sup>±0.5</sup>	—	(9.5)	—	17	1,000	9.8
020443	DR-22-SBS2	22	—	—	7	2	8 <sup>±0.5</sup>	—	(9.5)	—	17	1,000	10.3
020735	DR-26-SBS0.5	26	—	—	7	0.5 <sup>±0.3</sup>	8 <sup>±0.5</sup>	—	(9.5)	—	17	1,000	10.1
021001	DR-30-SBS0.5	30	—	—	7	0.5	8 <sup>±0.5</sup>	—	(9.5)	—	17	500	6.8
021100	DR-35-SBS0.5	35	—	—	7	0.5 <sup>±0.3</sup>	8 <sup>±0.5</sup>	—	(9.5)	—	17	300	4.0
040101	DR-18-SHS6-GN	18	6	—	6	—	—	—	(8.2)	—	18	2,500	7.8
040207	DR-19-SHS6	19	6	—	6	—	—	—	(8.2)	—	18	2,500	8.1
040404	DR-22-SHS6-GN	22	6	—	7	—	—	—	(9.5)	—	18	1,000	7.0
040414	DR-22-SHS8-GN	22	8	—	7	—	—	—	(11.0)	—	18	1,000	5.3
040801	DR-28-SHS6-GN	28	6	—	7	—	—	—	(9.5)	—	18	500	4.2
041601	DR-26-SHS10-GN	26	10	—	8	—	—	—	(13.0)	98 (10)	18	1,000	7.9
041611	DR-30-SHS10-GN	30	10	—	9	—	—	—	(14.5)	147 (15)	18	500	7.7
041613	DR-32-SHS12-GN	32	12	—	10	—	—	—	(17.0)	176 (18)	18	500	9.6
041615	DR-35-SHS15-GN	35	15	—	11	—	—	—	(21.0)	176 (18)	18	400	10.6
041617	DR-40-SHS17-GN	40	17	—	12	—	—	—	(21.0)	205 (21)	18	250	6.9
041619	DR-47-SHS20-GN	47	20	—	14	—	—	—	(27.0)	235 (24)	18	150	8.7
040103	DR-18-SHS8	18	8	—	5	—	—	—	(11.0)	—	19	3,000	8.7

\*1 参考値 Reference Dimension

\*2 許容荷重 (毎分300回 回転時) Allowable Load at 300min<sup>-1</sup> (300r.p.m)

\*3 上記以外のサイズ・形状につきましては、弊社までご相談ください。

Each limiting size can be changed for practical application. Please ask our engineer for further information.

※上記は受注生産品です。 These products manufactured to order.

## DO (外軸Rタイプ) RoHS

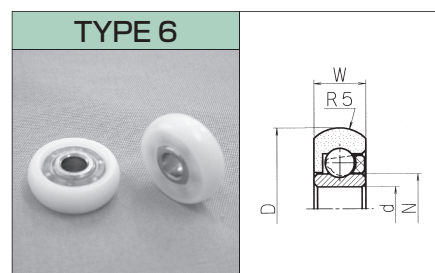
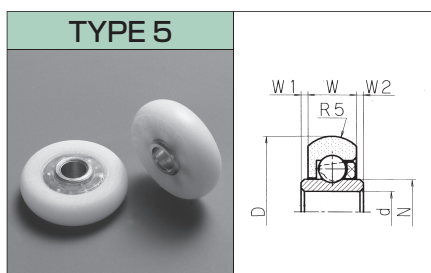
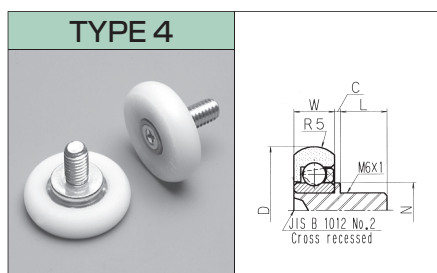
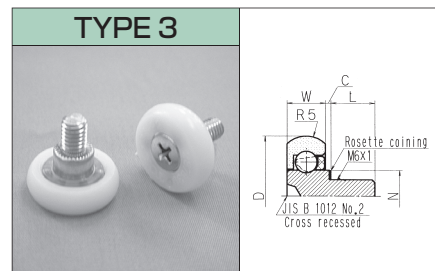
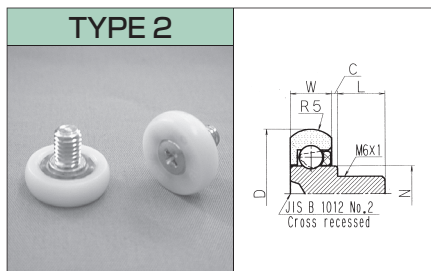
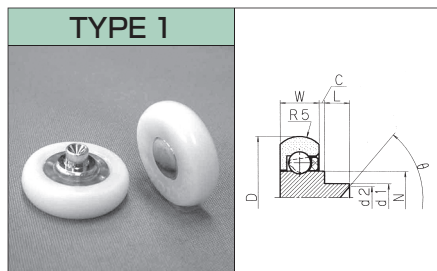

Code	Part No.	D <sub>-0.2</sub> [mm]	d <sup>+0.1</sup> [mm]	d1 <sub>-0.1</sub> [mm]	W <sub>-0.2</sub> [mm]	C <sup>±0.4</sup> [mm]	L <sup>±0.2</sup> [mm]	(d2 × θ) <sup>*1</sup>	W1 <sup>*1</sup> [mm]	W2 <sup>*1</sup> [mm]	N [mm]	Load <sup>*2</sup> [N] (kgf)	Type	Q'ty [pcs/box]	Gross Weight [kg/box]
070010	DO-19-A0.5	19	—	5	6	0.5	3.5	φ4 × 120°	—	—	(8.2)	29.4 ( 3)	1	2,000	10.8
070020	DO-22-A1	22	—	5	7	1	3.5	φ4.4 × 90°	—	—	(9.5)	78.4 ( 8)	1	1,000	8.9
070021	DO-22-A3	22	—	5	7	3	3.5	φ4 × 90°	—	—	(9.5)	78.4 ( 8)	1	1,000	9.3
070030	DO-24-A1	24	—	5	7	1	3.5	φ4.4 × 90°	—	—	(9.5)	78.4 ( 8)	1	1,000	9.8
070040	DO-26-A1	26	—	5	7	1	3.5	φ4.4 × 90°	—	—	(9.5)	78.4 ( 8)	1	1,000	10.3
071010	DO-19-B0.5	19	—	—	6	0.5	8 <sup>±0.5</sup>	—	—	—	(8.2)	49 ( 5)	2	2,000	12.5
071012	DO-19-B0.5-4.5	19	—	—	6	0.5	4.5 <sup>±0.5</sup>	—	—	—	(8.2)	49 ( 5)	2	2,000	10.3
071020	DO-22-B0.5	22	—	—	7	0.5	8 <sup>±0.5</sup>	—	—	—	(9.5)	196 (20)	2	1,000	9.3
071026	DO-22-B3-10.5	22	—	—	7	3	10.5 <sup>±0.5</sup>	—	—	—	(9.5)	196 (20)	2	1,000	10.4
071030	DO-24-B0.5	24	—	—	7	0.5	8 <sup>±0.5</sup>	—	—	—	(9.5)	196 (20)	2	1,000	10.3
071040	DO-26-B0.5	26	—	—	7	0.5	8 <sup>±0.5</sup>	—	—	—	(9.5)	196 (20)	2	1,000	10.7
071050	DO-28-B0.5	28	—	—	7	0.5	8 <sup>±0.5</sup>	—	—	—	(9.5)	196 (20)	2	500	6.3
071023	DO-22-B5	22	—	—	7	5	8 <sup>±0.5</sup>	—	—	—	(9.5)	196 (20)	3	1,000	11.2
071031	DO-24-B2	24	—	—	7	2	8 <sup>±0.5</sup>	—	—	—	(9.5)	196 (20)	3	1,000	10.8
071032	DO-24-B3	24	—	—	7	3	8 <sup>±0.5</sup>	—	—	—	(9.5)	196 (20)	3	1,000	11.8
071034	DO-24-B4	24	—	—	7	4	8 <sup>±0.5</sup>	—	—	—	(9.5)	196 (20)	3	1,000	11.6
071060	DO-30-B3	30	—	—	7	3	8 <sup>±0.5</sup>	—	—	—	(9.5)	196 (20)	3	500	6.4
071035	DO-24-BH0.5	24	—	—	7	0.5	8 <sup>±0.5</sup>	—	—	—	(9.5)	196 (20)	4	1,000	8.8
071045	DO-26-BH2-11	26	—	—	7	2	11 <sup>±0.5</sup>	—	—	—	(13.0)	196 (20)	4	800	10.1
072031	DO-24-H6W1	24	6	—	7	—	—	—	1	1	(9.5)	196 (20)	5	1,000	7.8
072043	DO-26-H6W1	26	6	—	7	—	—	—	1	1	(9.5)	196 (20)	5	1,000	8.5
072072	DO-35-H6W1	35	6	—	7	—	—	—	1	1	(9.5)	196 (20)	5	500	5.1
072080	DO-40-H6W0.5	40	6	—	8 <sub>-0.3</sub>	—	—	—	0.5	0.5	(9.5)	196 (20)	5	400	4.5
072000	DO-18-H5	18	5	—	6	—	—	—	—	—	(8.2)	49 ( 5)	6	2,500	8.1
072010	DO-19-H5	19	5	—	6	—	—	—	—	—	(8.2)	49 ( 5)	6	2,500	9.8
072020	DO-22-H6	22	6	—	7	—	—	—	—	—	(9.5)	196 (20)	6	1,500	8.9
072030	DO-24-H6	24	6	—	7	—	—	—	—	—	(9.5)	196 (20)	6	1,000	7.3
072040	DO-26-H6	26	6	—	7	—	—	—	—	—	(9.5)	196 (20)	6	1,000	8.0
072050	DO-28-H6	28	6	—	7	—	—	—	—	—	(9.5)	196 (20)	6	800	8.7
072060	DO-29-H6	29	6	—	7 <sub>-0.1</sub>	—	—	—	—	—	(9.5)	196 (20)	6	500	4.0

\*1 参考値 Reference Dimension

\*2 許容荷重 (毎分300回 回転時) Allowable Load at 300min<sup>-1</sup> (300r.p.m)

\*3 上記以外のサイズ・形状につきましては、弊社までご相談ください。Each limiting size can be changed for practical application. Please ask our engineer for further information.

## DU (外輪U溝タイプ) RoHS

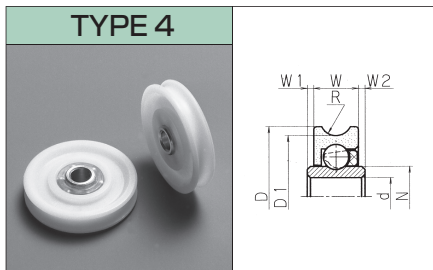
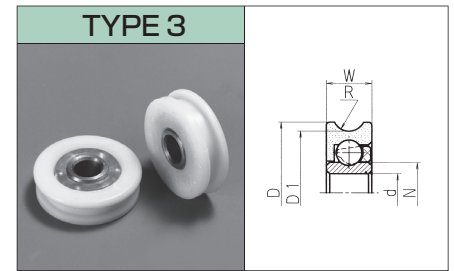
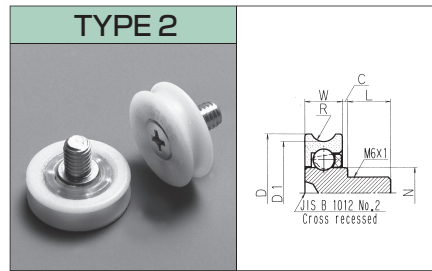
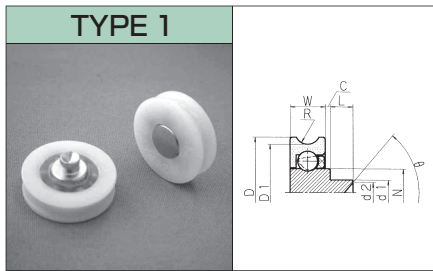

Code	Part No.	D <sup>±0.2</sup> [mm]	D1 <sup>±0.1</sup> [mm]	d <sup>+0.1</sup> [mm]	d1 <sup>-0.1</sup> [mm]	W <sup>-0.2</sup> [mm]	C <sup>±0.4</sup> [mm]	L <sup>±0.2</sup> [mm]	*1 (d2×θ)	W1 <sup>*1</sup> [mm]	W2 <sup>*1</sup> [mm]	R	N [mm]	Load <sup>*2</sup> [N] (kgf)	Type	Q'ty [pcs/box]	Gross Weight [kg/box]
080010	DU-19-A0.5	19	17	—	5	6	0.5	3.5	φ4 ×120°	—	—	1.75	(8.2)	29.4 ( 3)	1	2,000	10.3
080020	DU-22-A1	22	19.2	—	5	7	1	3.5	φ4.4× 90°	—	—	2.5	(9.5)	58.8 ( 6)	1	1,000	8.5
080030	DU-24-A1	24	21.2	—	5	7	1	3.5	φ4.4× 90°	—	—	2.5	(9.5)	58.8 ( 6)	1	1,000	9.3
080040	DU-26-A1	26	23.2	—	5	7	1	3.5	φ4.4× 90°	—	—	2.5	(9.5)	58.8 ( 6)	1	1,000	10.3
081010	DU-19-B0.5	19	17	—	—	6	0.5	8 <sup>±0.5</sup>	—	—	—	1.75	(8.2)	39.2 ( 4)	2	2,000	12.4
081013	DU-19-B2	19	17	—	—	6	2	8 <sup>±0.5</sup>	—	—	—	1.75	(8.2)	39.2 ( 4)	2	2,000	12.8
081020	DU-22-B0.5	22	19.2	—	—	7	0.5	8 <sup>±0.5</sup>	—	—	—	2.5	(9.5)	156 (16)	2	1,000	9.8
081021	DU-22-B6	22	19.2	—	—	7	6	8 <sup>±0.5</sup>	—	—	—	2.5	(9.5)	156 (16)	2	1,000	11.8
081030	DU-24-B0.5	24	21.2	—	—	7	0.5	8 <sup>±0.5</sup>	—	—	—	2.5	(9.5)	156 (16)	2	1,000	10.5
081040	DU-26-B0.5	26	23.2	—	—	7	0.5	8 <sup>±0.5</sup>	—	—	—	2.5	(9.5)	156 (16)	2	1,000	11.3
082010	DU-19-H5	19	17	5	—	6	—	—	—	—	—	1.75	(8.2)	39.2 ( 4)	3	2,500	9.8
082020	DU-22-H6	22	19.2	6	—	7	—	—	—	—	—	2.5	(9.5)	156 (16)	3	1,500	8.8
082060	DU-24-H6	24	21.2	6	—	7	—	—	—	—	—	2.5	(9.5)	156 (16)	3	1,000	6.7
082070	DU-26-H6	26	23.2	6	—	7	—	—	—	—	—	2.5	(9.5)	156 (16)	3	1,000	7.4
082100	DU-30-H6-M	30	25.7	6	—	7 <sup>±0.2</sup>	—	—	—	—	—	2.5	(9.5)	156 (16)	3	500	3.6
082101	DU-30-H10	30	26	10	—	8 <sup>±0.2</sup>	—	—	—	—	—	2.5	(14.5)	196 (20)	3	500	6.1
082031	DU-22-H6W0.5	22	19	6	—	7	—	—	—	0.5	0.5	2.5	(9.5)	156 (16)	4	1,500	5.8
082028	DU-22-H6W1	22	19.2	6	—	7	—	—	—	1	1	2.5	(9.5)	156 (16)	4	1,000	6.2
082090	DU-28-H6W1	28	24	6	—	7	—	—	—	1	1	2.5	(9.5)	156 (16)	4	800	8.0
082103	DU-30-H6W1	30	25.7	6	—	7	—	—	—	1	1	2.5	(9.5)	156 (16)	4	500	6.1
082110	DU-35-H6W1	35	31	6	—	7	—	—	—	1	1	2.5	(9.5)	156 (16)	4	500	5.8
082120	DU-40-H6W0.5	40	36	6	—	8 <sup>±0.2</sup>	—	—	—	0.5	0.5	2.5	(9.5)	156 (16)	4	400	5.4

\*1 参考値 Reference Dimension

\*2 許容荷重 (毎分300回 回転時) Allowable Load at 300min<sup>-1</sup> (300r.p.m)

\*3 上記以外のサイズ・形状につきましては、弊社までご相談ください。Each limiting size can be changed for practical application. Please ask our engineer for further information.



## DV (外軸V溝タイプ) RoHS

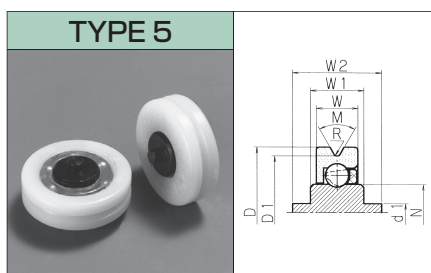
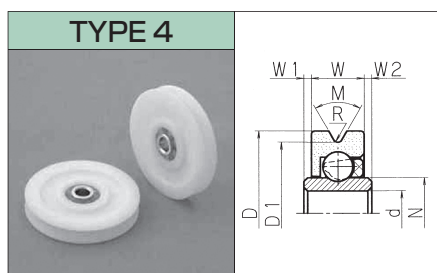
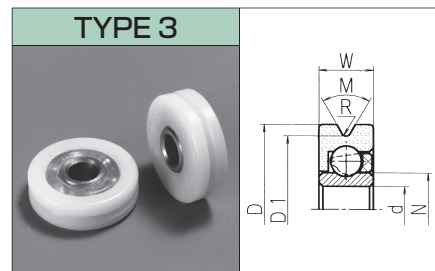
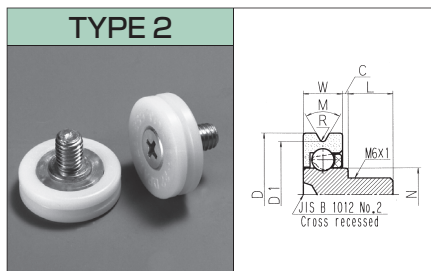
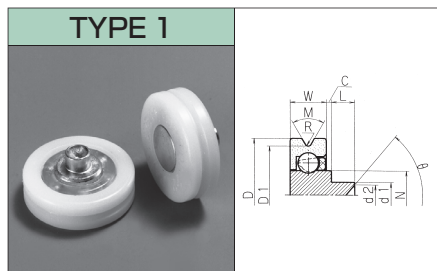

Code	Part No.	D <sup>±0.2</sup> [mm]	D1 <sup>±0.2</sup> [mm]	d <sup>+0.1</sup> <sub>0</sub> [mm]	d1 <sup>0</sup> <sub>-0.1</sub> [mm]	W <sup>0</sup> <sub>-0.2</sub> [mm]	C <sup>±0.4</sup> [mm]	L <sup>±0.2</sup> [mm]	*1 (d2 × θ)	W1 <sup>*1</sup> [mm]	W2 <sup>*1</sup> [mm]	M°	R	N [mm]	Type	Q'ty [pcs/box]	Gross Weight [kg/box]
090000	DV-19-A0.5	19	17	—	5	6	0.5	3.5	φ4 ×120°	—	—	60	0.6	(8.2)	1	2,000	11.0
090100	DV-22-A1	22	19	—	5	7	1	3.5	φ4.4 × 90°	—	—	60	0.6	(9.5)	1	1,000	9.2
090200	DV-24-A1	24	21	—	5	7	1	3.5	φ4.4 × 90°	—	—	60	0.6	(9.5)	1	1,000	9.8
090300	DV-26-A1	26	23	—	5	7	1	3.5	φ4.4 × 90°	—	—	60	0.6	(9.5)	1	1,000	10.6
090400	DV-28-A1	28	24	—	5	7	1	3.5	φ4.4 × 90°	—	—	60	0.6	(9.5)	1	500	5.3
090500	DV-30-A1	30	27	—	5	7	1	3.5	φ4.4 × 90°	—	—	60	0.6	(9.5)	1	500	6.5
090600	DV-38-A0.5	38	35	—	5	8 <sup>±0.2</sup>	0.5	3.5	φ4.4 × 90°	—	—	60	0.6	(9.5)	1	500	7.5
091000	DV-19-B0.5	19	17	—	—	6	0.5	8 <sup>±0.5</sup>	—	—	—	60	0.6	(8.2)	2	2,000	12.6
091100	DV-22-B0.5	22	19	—	—	7	0.5	8 <sup>±0.5</sup>	—	—	—	60	0.6	(9.5)	2	1,000	10.0
091200	DV-24-B0.5	24	21	—	—	7	0.5	8 <sup>±0.5</sup>	—	—	—	60	0.6	(9.5)	2	1,000	10.6
091201	DV-24-B3	24	21	—	—	7	3	8 <sup>±0.5</sup>	—	—	—	60	0.6	(9.5)	2	1,000	10.7
091300	DV-26-B0.5	26	23	—	—	7	0.5	8 <sup>±0.5</sup>	—	—	—	60	0.6	(9.5)	2	1,000	11.2
091500	DV-30-B0.5-0.5R	30	28	—	—	7	0.5	8 <sup>±0.5</sup>	—	—	—	90	0.5	(9.5)	2	500	8.0
091501	DV-32.5-B1.5-2R	32.5	20.5	—	—	9.5 <sup>±0.2</sup>	1.5	8 <sup>±0.5</sup>	—	—	—	15	2	(9.5)	2	400	6.6
091600	DV-38-B0.5	38	35	—	—	8 <sup>±0.2</sup>	0.5	8 <sup>±0.5</sup>	—	—	—	60	0.6	(9.5)	2	250	5.8
092001	DV-19-H5	19	17	5	—	6	—	—	—	—	—	60	0.6	(8.2)	3	2,500	10.0
092100	DV-22-H6-M	22	19	6	—	7	—	—	—	—	—	60	0.6	(9.5)	3	1,500	9.7
092200	DV-24-H6	24	21	6	—	7	—	—	—	—	—	60	0.6	(9.5)	3	1,000	7.4
092201	DV-24-H8	24	20 <sup>±1</sup>	8	—	7	—	—	—	—	—	30	0.6	(11.0)	3	1,000	5.6
092300	DV-26-H6	26	23	6	—	7	—	—	—	—	—	60	0.6	(9.5)	3	1,000	8.0
092500	DV-30-H6	30	27	6	—	7	—	—	—	—	—	60	0.6	(9.5)	3	500	6.8
092700	DV-48-H6W0.4-1.6R	48.3	35	6	—	8.2 <sup>±0.2</sup>	—	—	—	0.4	0.4	30	1.6	(9.5)	4	250	4.1
090102	DV-22-AW0.5-B	22 <sup>-0.1</sup>	19 <sup>±0.1</sup>	—	3	7	—	—	—	8	12	60	0.65	(9.5)	5	1,000	8.9

\*1 参考値 Reference Dimension

\*2 上記以外のサイズ・形状につきましては、弊社までご相談ください。Each limiting size can be changed for practical application. Please ask our engineer for further information.

※ 上記は受注生産品です。These products manufactured to order.

## DH (外輪凹溝タイプ) RoHS

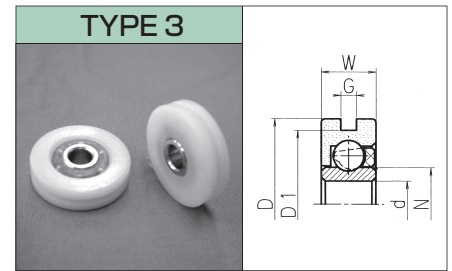
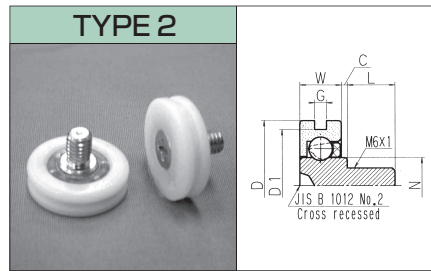
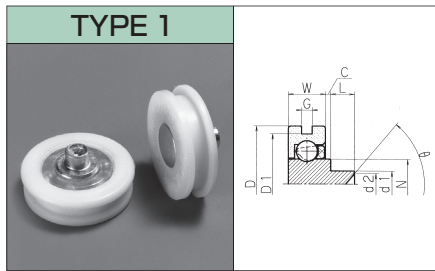

Code	Part No.	D <sup>±0.2</sup> [mm]	D1 <sup>±0.2</sup> [mm]	d <sup>+0.1</sup> [mm]	d1 <sup>-0.1</sup> [mm]	W <sup>-0.2</sup> [mm]	C <sup>±0.4</sup> [mm]	L <sup>±0.2</sup> [mm]	(d2×θ) <sup>*1</sup>	G <sup>±0.2</sup> [mm]	N [mm]	Type	Q'ty [pcs/box]	Gross Weight [kg/box]
100000	DH-16-A0.5	19	16	—	5	6	0.5	3.5	φ4×120°	2.1	(8.2)	1	2,000	10.9
101012	DH-16-B0.5	19	16	—	—	6	0.5	8 <sup>±0.5</sup>	—	2.1	(8.2)	2	2,000	12.5
101013	DH-16-B1	19	16	—	—	6	1	8 <sup>±0.5</sup>	—	2.1	(8.2)	2	2,000	11.8
101020	DH-19-B0.5-2	22	19	—	—	7	0.5	8 <sup>±0.5</sup>	—	2	(9.5)	2	1,000	9.9
101040	DH-21-B0.5-2	24	21	—	—	7	0.5	8 <sup>±0.5</sup>	—	2	(9.5)	2	1,000	10.5
102010	DH-16-H5	19	16	5	—	6	—	—	—	2.1	(8.2)	3	2,000	9.9
102021	DH-19-H6-2	22	19	6	—	7	—	—	—	2	(9.5)	3	1,000	9.6
102025	DH-19-H6-2.5	22	19	6	—	7	—	—	—	2.5	(9.5)	3	1,500	8.4
102040	DH-21-H6-2	24	21	6	—	7	—	—	—	2	(9.5)	3	1,000	7.3
102041	DH-21-H6-3	24	21	6	—	7	—	—	—	3	(9.5)	3	1,000	6.5
102042	DH-21-H6-3.2	24	21	6	—	7	—	—	—	3.2	(9.5)	3	1,000	6.2

\*1 参考値 Reference Dimension

\*2 上記以外のサイズ・形状につきましては、弊社までご相談ください。Each limiting size can be changed for practical application. Please ask our engineer for further information.

※上記は受注生産品です。These products manufactured to order.

## DF (外輪フランジタイプ) RoHS

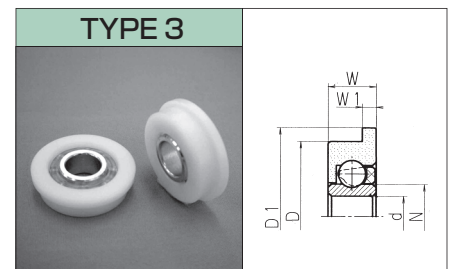
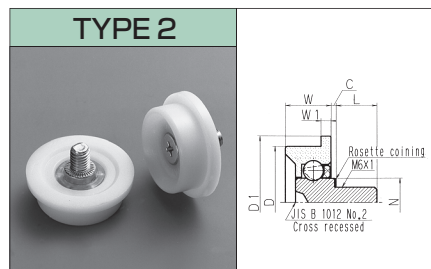
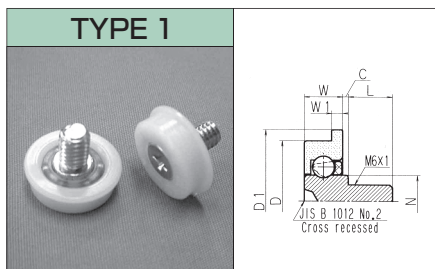

Code	Part No.	D <sup>-0.1</sup> [mm]	D1 <sup>±0.2</sup> [mm]	d <sup>+0.1</sup> [mm]	W <sup>-0.2</sup> [mm]	W1 <sup>±0.2</sup> [mm]	C <sup>±0.4</sup> [mm]	L <sup>±0.5</sup> [mm]	N [mm]	Load <sup>*1</sup> [N] (kgf)	Load <sup>*2</sup> [N] (kgf)	Type	Q'ty [pcs/box]	Gross Weight [kg/box]
061001	DF-17-B0.5	17	19	—	6	1	0.5	8	(8.2)	49 (5)	—	1	1,500	10.0
061020	DF-22-B0.5	22	26	—	7	2	0.5	8	(9.5)	196 (20)	—	1	1,000	9.4
061040	DF-26-B1	26 <sup>±0.2</sup>	32	—	11 <sup>±0.2</sup>	3	1	8	(9.5)	196 (20)	—	2	400	5.3
061043	DF-26-B2	26 <sup>±0.2</sup>	32	—	11 <sup>±0.2</sup>	3	2	8	(9.5)	196 (20)	—	2	400	5.8
062000	DF-17-H6	17	19 <sup>±0.1</sup>	6	6	1 <sup>±0.1</sup>	—	—	(8.2)	49 (5)	14.7 (1.5)	3	3,000	9.5
062005	DF-19-H6	19	22	6	7	1.5	—	—	(9.5)	147 (15)	29.4 (3)	3	1,500	7.7
062020	DF-22-H6	22	26	6	7	2	—	—	(9.5)	196 (20)	39.2 (4)	3	1,500	9.5
062027	DF-23-H10	23	24.75	10	8 <sup>±0.2</sup>	1.5 <sup>±0.1</sup>	—	—	(13.0)	98 (10)	39.2 (4)	3	1,000	7.2
062061	DF-30-H10-3	30	34	10	8.5 <sup>±0.2</sup>	3	—	—	(14.5)	245 (25)	58.8 (6)	3	500	7.0
062062	DF-32-H12	32	36	12	10	3	—	—	(17.0)	245 (25)	58.8 (6)	3	400	7.5

\*1 アウターレース回転許容荷重 (毎分 300 回 回転時) Allowable Load at 300min<sup>-1</sup> (300r.p.m) rotation of outer-race

\*2 インナーレース回転許容荷重 (毎分 300 回 回転時) Allowable Load at 300min<sup>-1</sup> (300r.p.m) rotation of inner-race

\*3 上記以外のサイズ・形状につきましては、弊社までご相談ください。Each limiting size can be changed for practical application. Please ask our engineer for further information.

## DL (カシメ軸付きローラー, ネジ軸付きローラー) RoHS

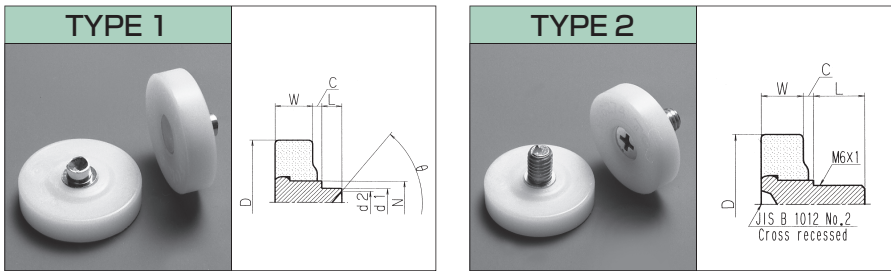

Code	Part No.	D <sub>-0.1</sub> <sup>0</sup> [mm]	d1 <sub>-0.1</sub> <sup>0</sup> [mm]	W <sub>-0.2</sub> <sup>0</sup> [mm]	C <sup>±0.4</sup> [mm]	L <sup>±0.2</sup> [mm]	(d2×θ) <sup>*1</sup>	N [mm]	Type	Q'ty [pcs/box]	Gross Weight [kg/box]
240012	DL-16-A0.5	16	4	5	0.5	3.6	nothing	(7.6)	1	2,500	3.2
240021	DL-19-A1.6	19	5	6.6	1.6	3.5	φ4×100°	(7.6)	1	2,000	10.4
240040	DL-22-A1.6	22	5	6.6	1.6 <sup>±0.5</sup>	3.5	φ4×100°	(7.6)	1	1,000	6.5
240080	DL-26-A1.6	26	5	6.6	1.6	3.5	φ4×100°	(7.6)	1	1,000	7.5
240120	DL-19-B1.6	19	—	6.6	1.6	8 <sup>±0.5</sup>	—	(7.6)	2	1,500	9.0
240140	DL-22-B1.6	22	—	6.6	1.6	8 <sup>±0.5</sup>	—	(7.6)	2	1,000	7.4
240159	DL-22-B2.6-7170	22	—	6.7 <sup>±0.2</sup>	2.6	8 <sup>±0.5</sup>	—	(7.6)	2	1,000	8.3
240145	DL-22-B5	22	—	6.7 <sup>±0.2</sup>	5	8 <sup>±0.5</sup>	—	(7.8)	2	1,000	9.9
240152	DL-22-B8.7	22 <sup>±0.2</sup>	—	7 <sup>±0.2</sup>	8.7	11 <sup>±0.5</sup>	—	(7.8)	2	1,000	11.7
240180	DL-26-B1.6	26	—	6.6	1.6	8 <sup>±0.5</sup>	—	(7.6)	2	1,000	9.0

\*1 参考値 Reference Dimension

\*2 上記以外のサイズ・形状につきましては、弊社までご相談ください。

Each limiting size can be changed for practical application. Please ask our engineer for further information.

## ER (帯電防止) Electrification Prevention

特長 1. アウターレースに導電性樹脂、潤滑剤に導電グリスを採用することにより、ベアリングの静電気の帯電を防止します。

FEATURE 1. Electrification of static electricity of bearings is prevented by adopting conductive resin for outer races and electric conduction grease.

Code	Part No.	D [mm]	W [mm]	C <sup>±0.4</sup> [mm]	L <sup>±0.5</sup> [mm]	N [mm]
720104	ER-19-B0.5	19 <sub>-0.1</sub> <sup>0</sup>	6 <sup>±0.2</sup>	0.5	8	(8.2)
720101	ER-22-B2	22 <sup>±0.2</sup>	7 <sub>-0.2</sub> <sup>0</sup>	2	8	(9.5)
720102	ER-22-B6	22 <sup>±0.2</sup>	7 <sub>-0.2</sub> <sup>0</sup>	6	8	(9.5)
720103	ER-26-B0.5	26 <sub>-0.1</sub> <sup>+0.3</sup>	7 <sub>-0.3</sub> <sup>0</sup>	0.5	8	(9.5)

※仕様は、弊社までご相談ください。  
※他のサイズでも制作検討致します。  
※上記は受注生産品です。

※Please ask our engineer for further information.  
※Each limiting size can also be supplied.  
※These products manufactured to order.

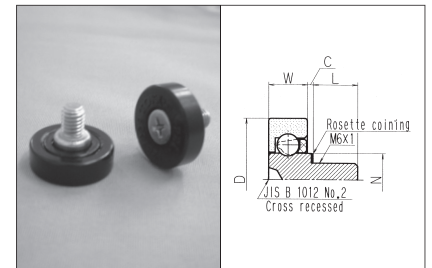

電気抵抗値 (参考データ)  
Electric resistance value (reference)

単位: kΩ  
unit

sample	1	2	3	4	平均値 average
電気抵抗値	174.8	221.8	221.5	131.3	187.4

※ラジアル荷重49N (5kgf) をかけ、3分間静止後、アウターレースとインナーレース間で電気抵抗値を測定。  
※An electrical resistance value of the bearing between outer race and inner race is measured after applying radial load, 49N(5kg), to the bearings for 3minutes.